

**M 26**



**EN Use and Maintenance**

**CE**

ghibli HG  
wirbel BEGG

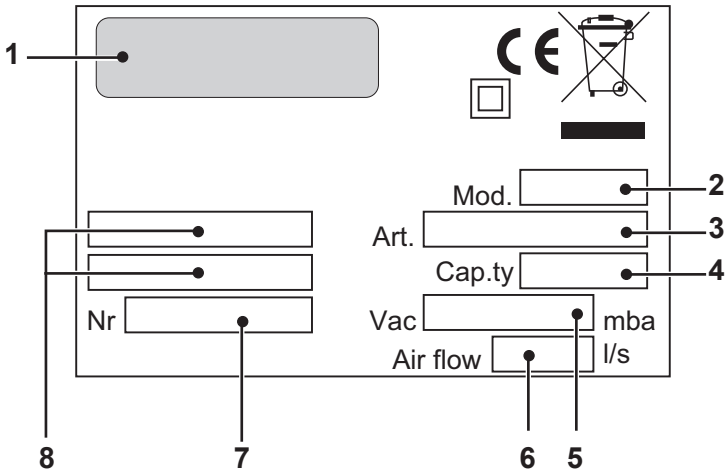
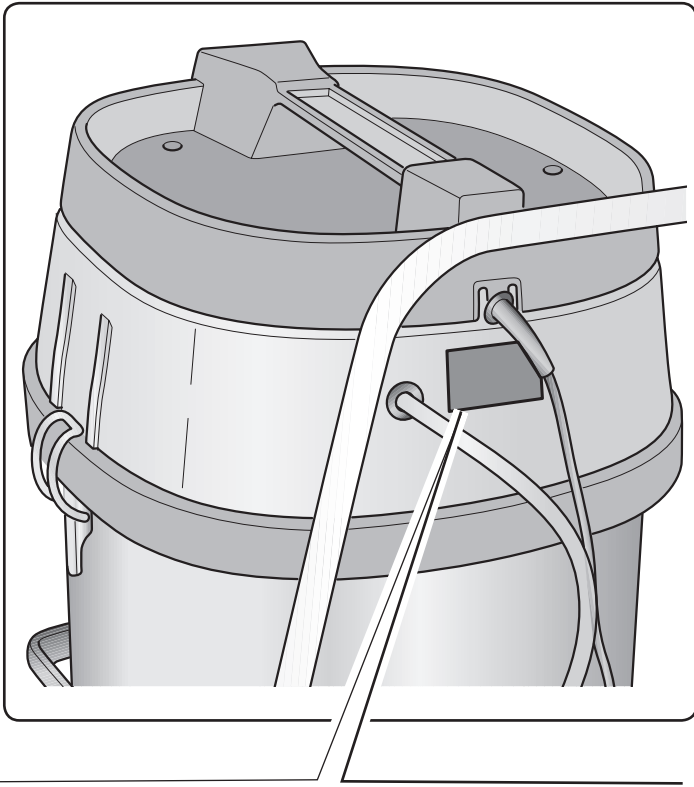

	1	2	3	4
IT	Produttore	Modello	Articolo	Capacità fusto
EN	Manufacturer	Model	Article	Container capacity
FR	Producteur	Modèle	Article	Capacité de la cuve
DE	Hersteller	Modell	Artikel	Fassungsvermögen des Körpers
ES	Fabricante	Modelo	Artículo	Capacidad del bidón
PT	Produtor	Modelo	Artigo	Capacidade do reservatório
NL	Producent	Model	Artikel	Inhoud reservoir
CS	Výrobce	Model	Typ	Obsah nádoby
RU	Изготовитель	Модель	Артикул	Емкость бака

	5	6	7	8
IT	Capacità aspirazione	Portata d'aria	N° Matricola	Caratteristiche elettriche
EN	Vacuum	Air flow	Serial N°	Electrical characteristics
FR	Capacité d'aspiration	Débit d'air	N° Matricule	Caractéristiques électriques
DE	Ansaugleistung	Luftdurchsatz	Matrikelnr.	Elektrische Eigenschaften
ES	Capacidad de aspiración	Caudal de aire	N° Matricola	Características eléctricas
PT	Capacidade de aspiração	Caudal de ar	Número de série	Características elétricas
NL	Zuigcapaciteit	Luchtdebiet	Serienummer	Elektrische eigenschappen
CS	Sací výkon	Množství dopravovaného vzduchu	Výrobní č.	Elektrické údaje
RU	Мощность всасывания	Расход воздуха	Заводской №	Электрические характеристики

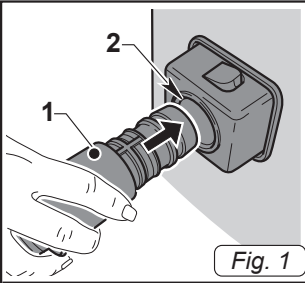

Fig. 1

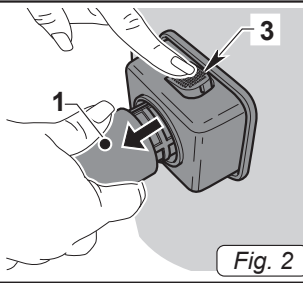

Fig. 2

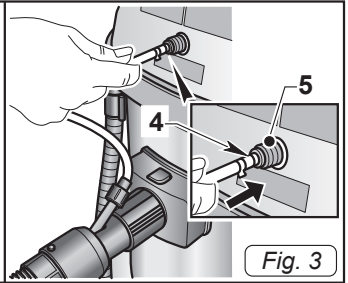

Fig. 3

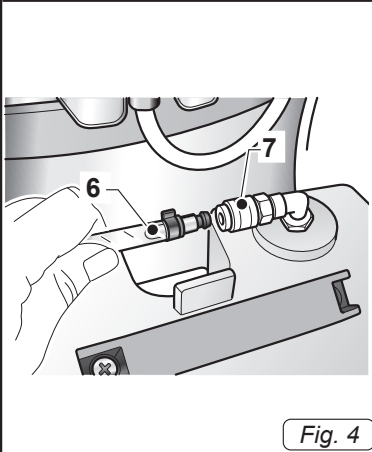

Fig. 4

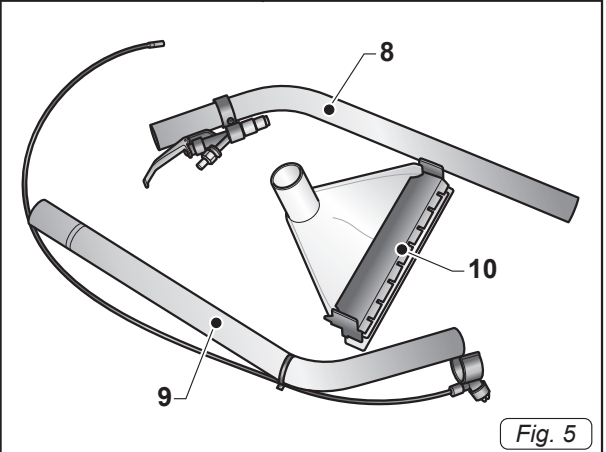

Fig. 5

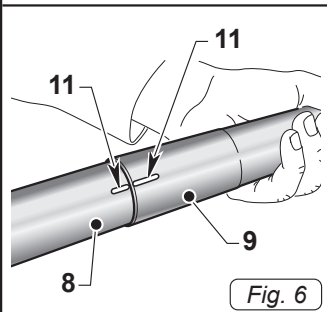

Fig. 6

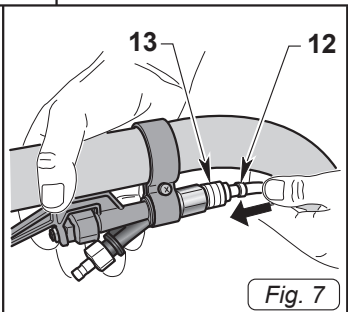

Fig. 7

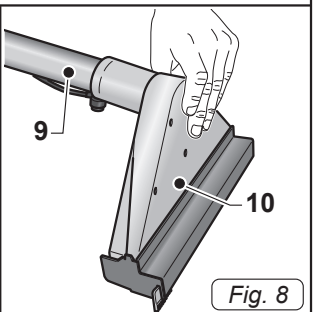

Fig. 8

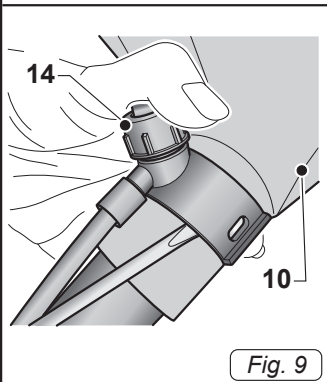

Fig. 9

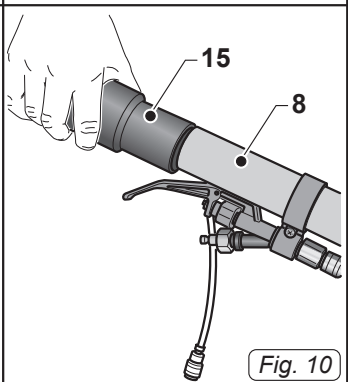

Fig. 10

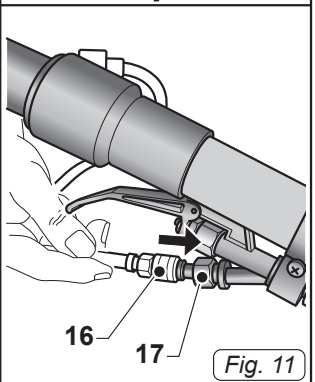
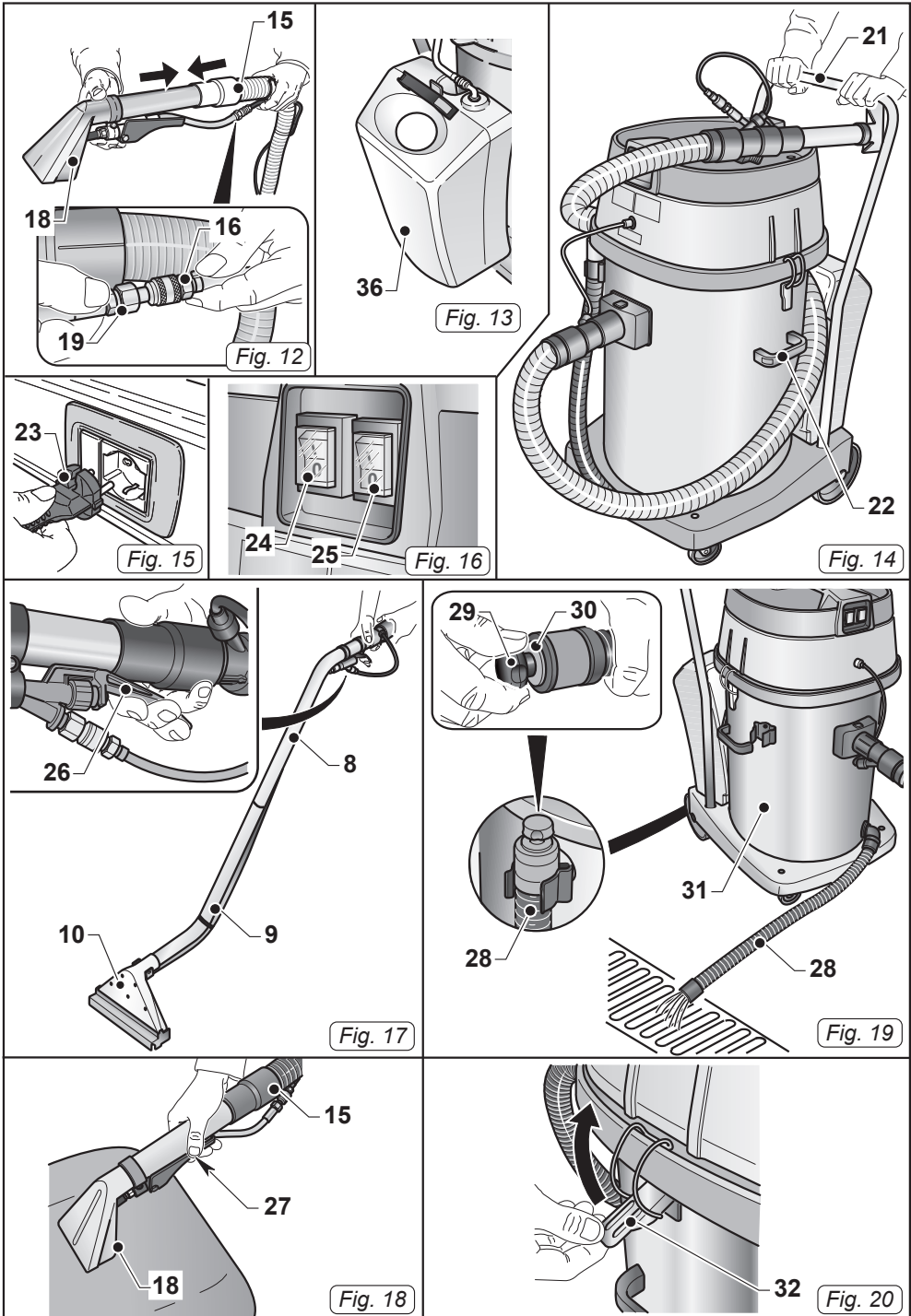
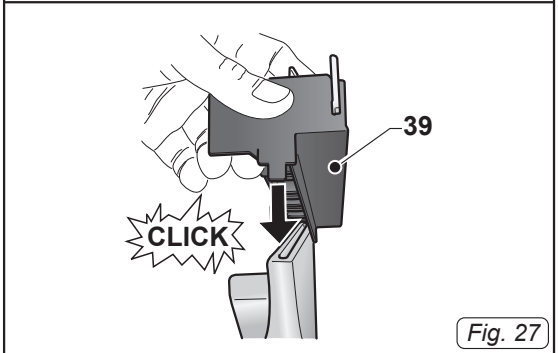
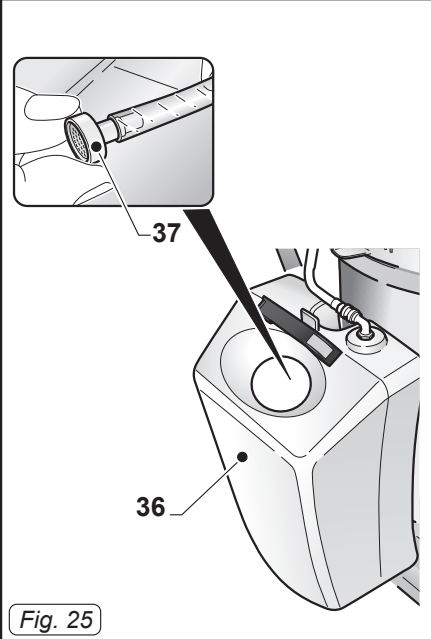
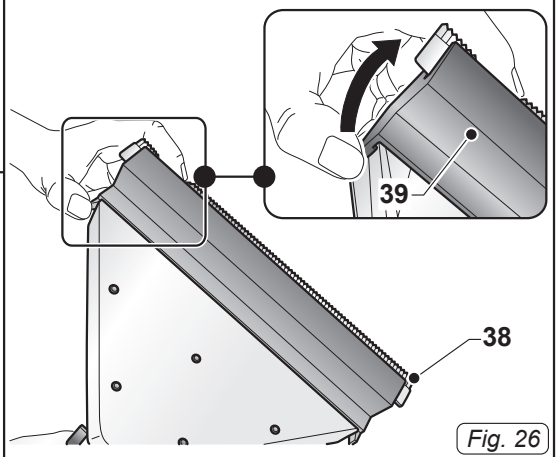
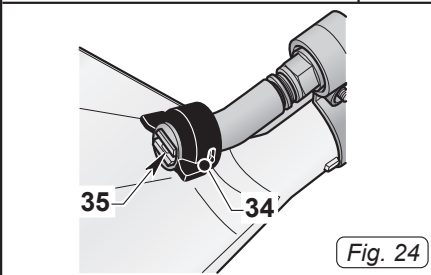
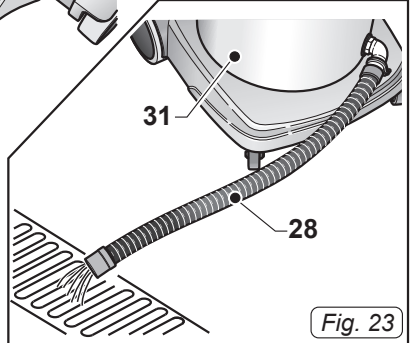
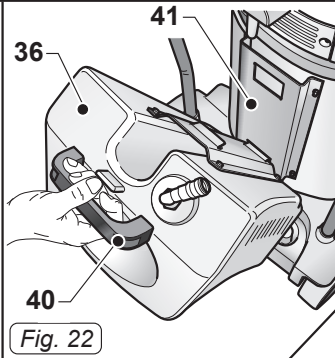
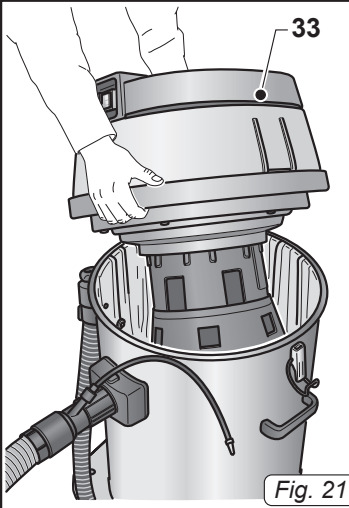

Fig. 11







English ..... ENGLISH - 1  
*(Translation of original instructions)*





## TECHNICAL CHARACTERISTICS

Voltage .....	See data plate
Motors power .....	1900 W
Sound level .....	65 dB(A)
Depression .....	190 mbar
Useful capacity tank .....	56 l
Detergent tank capacity .....	11 l
Dimensions .....	610 x 540 x 920H mm
Weight .....	24,5 kg
Accessories .....	Ø 40 mm

## TYPE OF USE

This appliance was designed for spray washing and extracting any type of fabric, carpet, car seats, floors etc.

It can be used as a vacuum cleaner and or solid and liquid suction unit with the appropriate accessories upon request.

It has only been designed for these uses.



### **DANGER:**

**The manufacturer can not be held responsible for any damage due to improper or incorrect use.**

**Any other use releases the manufacturer from liability for harm to persons and/or property and invalidates any warranty condition.**

## IMPROPER USE

Do not use the appliance to:

- Aspirate flammable, explosive, corrosive and toxic substances.
- Aspirate hot substances.
- Do not use the appliance in liquid suction mode to suction powder and vice versa.

Do not use the appliance in areas at risk of explosion.

## PREPARING THE APPLIANCE

### Assembling the hoses

- Insert, as far as possible, the sleeve (1 Fig. 1) of the suction hose into the nozzle (2 Fig. 1) on the drum.
- To release the sleeve (1 Fig. 2) press and hold the button (3 Fig. 2) and then pull out the sleeve (1 Fig. 2).
- Connect the (4 Fig. 3) detergent delivery hose to the quick coupling (5 Fig. 3); to release it push the quick coupling (5 Fig. 3) inwards.
- Connect the (6 Fig. 4) detergent suction hose to the quick coupling (7 Fig. 4); to release it push the quick coupling (7 Fig. 4) inwards.

### Rigid pipe assembly for washing carpets or floors (if present)

After connecting the suction hose to the outlet the drum, do as follows:

- Remove the hose from its stiff as follows:
  - Top Tube (8 Fig. 5).
  - Lower Hose (9 Fig. 5) complete with pipe cleaner and nozzle.
  - Nozzle for carpets and floor coverings (10 Fig 5).
- Hook the two rigid extensions (8 and 9 Fig. 6), matching the two references (11 Fig. 6)
- Connect the hose (12 Fig. 7) coming from the nozzle quick connector (13 Fig. 7) of the dispenser lever; push the lever to release, the quick connector (13 Fig. 7).
- Insert the floor nozzle (10 Fig. 8) into the tube (9 Fig. 8).
- Place the nozzle (14 Fig. 9) on the mouthpiece (10 Fig. 9) hooking it into the appropriate bumps in the nozzle (10 Fig. 9).
- Insert the tube (8 Fig. 10) in the hose (15 Fig. 10)
- Connect the quick connector (16 Fig. 11) of the supply pipe to the fitting (17 Fig. 11) of the dispensing; to release the quick connector (16 Fig.11) push lever to the outside of the tube.

## Professional hose assembly for fabric washing (if present)

After connecting the suction hose to the outlet the drum, do as follows:

- Insert the fabric nozzle (18 Fig. 12) into the flexible hose (15 Fig. 12).
- Connect the detergent hose (19 Fig. 12) to the quick coupling (16 Fig. 12) on the flexible hose; to release it push the quick coupling (16 Fig. 12) towards the hose.

## Filling the detergent tank

- Pour into the tank (36 Fig. 13) the detergent necessary for cleaning.



### NOTE:

For detergent dosing refer to the manufacturer's instructions.

## USING THE APPLIANCE

- The appliance is fitted with wheels and can therefore be pulled along using the flexible hose, or pushed with the handle (21 Fig. 14)
- For lifting, two people, put your fingers in its handles (22 Fig. 14).

## Starting up the appliance

- Insert the plug (23 Fig. 15) into the electrical socket.
- Press the switch (24 Fig. 16) to "I" to start the engine intake.
- Push the switch (25 Fig. 16) on "I" to start the detergent pump; the switch lights up.



### NOTE:

The suction motor and the detergent pump operate independently; therefore, it is possible to:

- wash fabrics or floors/ carpets by starting only the detergent pump;
- wash and suction liquid simultaneously by starting up the detergent pump and

suction motor at the same time;

- suction liquids by only starting the suction motor.

## Washing floors or carpets

- For washing floors or carpeting is necessary to fit the rigid tube (8-9 Fig. 17) and the mouth floor (10 Fig. 17), if present.
- Put the nozzle (10 Fig. 17) perpendicular to the floor / carpet (see Figure 17).
- Start the suction motor and the detergent pump by pressing the relative switches (24 - 25 Fig. 16).
- Press the lever (26 Fig. 17) to deliver the cleaner, release to stop dispensing.
- The detergent released washes the floor/ carpet / and the dirty liquid is suctioned into the tank of the appliance.

For very dirty areas it is recommended you apply detergent to the dirty area without suctioning it; leave the detergent allowing it to work for several seconds and then wash the area and suction the dirt.



### NOTE:

To prevent the detergent pump from breaking, it is recommended that you stop its operation, pushing the relative switch, when dosing has not occurred for several minutes.



### NOTE:

When the recovery tank is full, noise increases and the appliance does not suction; therefore, switch it off and empty the tank as described in the relevant paragraphs.

## Cleaning chairs

- Start the suction motor and the detergent pump by pressing the relative switches (24 - 25 Fig. 16).
- Place the mouthpiece on the fabric and press lightly; then press the lever (27 Fig. 18) to deliver the cleaner, release to stop dispensing.

- For very dirty areas it is recommended you apply detergent to the dirty area without suctioning it; leave the detergent allowing it to work for several seconds and then wash the area and suction the dirt.



**NOTE:**

To prevent the detergent pump from breaking, it is recommended that you stop its operation, pushing the relative switch, when dosing has not occurred for several minutes.



**NOTE:**

When the recovery tank is full, noise increases and the appliance does not suction; therefore, switch it off and empty the tank as described in the relevant paragraphs

### Switching off the appliance

- Press the switches (24 and 25 Fig. 16) to "0" to switch off the appliance; the lamps on the switches will go out.
- Remove the plug (23 Fig. 15) from the electrical socket.

## CLEANING AND MAINTENANCE



**DANGER:**

**Before performing any maintenance operations, unplug the appliance from the electrical socket.**

### Daily cleaning

#### Emptying the recovery tank

- Position yourself over a floor drain with the appliance.
- Detach the drain hose (28 Fig. 19) from its relative support.
- Unscrew the knob (29 Fig. 19) and remove the cap (30 Fig. 19) of the water

drain hose (28 Fig. 19) and empty the liquid into the recovery tank (31 Fig. 19).

#### Cleaning the detergent dosing circuit

At the end of each workday, clean the detergent dosing circuit as follows to prevent clogging:

- Release pressure from the circuit by pressing, with dosing pump off, the lever (27 Fig. 18) or lever (26 Fig. 17)
- Disconnect the detergent delivery hose (4 Fig. 3).
- Lift up the levers (32 Fig. 20) and remove the cover (33 Fig. 21) complete with motor.
- Disconnect the detergent suction hose (6 Fig. 4).
- Remove the detergent container (36 Fig. 22) lifting it by the dedicated handle (40 Fig. 22).
- Empty the remaining liquid into a suitable container.
- Wash the inside of the detergent container with running water.
- Put the detergent container back in place, attaching it to the dedicated bracket (41 Fig. 22) fixed to the tank.
- Connect the detergent (6 Fig. 4) suction hose to the quick coupling (7 Fig. 4).
- Pour clean water into the detergent container, electrically connect the appliance and start the dosing pump by pressing the switch (25 Fig. 16).
- Clean the circuit by pressing the lever (27 Fig. 18) or (26 Fig. 17), depending on the type of mouthpiece.
- Dispense the liquid from the nozzle until clean water comes out.
- Empty the water in the detergent tank as described above.

#### Cleaning the appliance body

- Clean the unit body with a cloth dampened with water or a mild detergent.
- Remove the cover as indicated previously and clean the inside of the tank with running water, leaving the drain hose open (28 Fig. 23) then reassemble even-

rything proceeding in reverse order.



### **DANGER:**

**Do not wash the appliance using jets of water.**

## **Periodic checks**

### **Cleaning the detergent dispensing nozzle**

If you note that the detergent is not dispensed evenly, clean the nozzle as described below:

- Remove the ring nut (34 Fig. 24).
- Remove the nozzle (35 Fig. 24) and clean it with running water, if it is clogged use a pin being careful not to distort the shape of the nozzle.
- Reassemble all of the parts performing these operations in the reverse order.

### **Cleaning the detergent suction filter**

If you note that the detergent is not being suctioned properly, check and clean the suction filter located inside the detergent tank.

- Using a screw driver, loosen the suction cap (36 Fig. 25) and remove it from the tank with the relative suction hose.
- Remove the filter (37 Fig. 25) and wash it under running water; if it is too clogged it should be replaced.
- Reassemble all of the parts performing these operations in the reverse order.

### **Replacing the floor nozzle squeegee (if present)**

If when washing the floors the washing liquid is not suctioned properly and the floor or carpet remains wet, check the condition of the squeegee (38 Fig. 26).

If the blade is worn or damaged should be replaced by releasing the blade support (39 Fig. 26) from the nozzle.

When replacing the new blade pay attention to insert it properly into the mouthpiece, then

press until you hear the click coupling (Fig. 27).

## **SPARE PARTS**

Slide nozzle body .....Code 7217519

<b>PROBLEM</b>	<b>CAUSE</b>	<b>SOLUTION</b>
The vacuum cleaner does not work.	Switch not pressed. Plug not inserted. Power cut.	Press the switch. Insert the plug into the socket. Check the power line.
Suction is not satisfactory.	Accessories or tubes clogged. Suction nozzle squeegee worn or damaged.	Check and clean the flexible hose and the suction nozzle. Check and replace the squeegee.
Detergent dispensing not even.	Nozzle clogged. Filter clogged.	Clean nozzle. Clean suction filter.
Detergent dispensing not working.	Switch not pressed. Thermal protection enabled.	Press the switch. Wait approx. 30 second for automatic reset.





DEALER

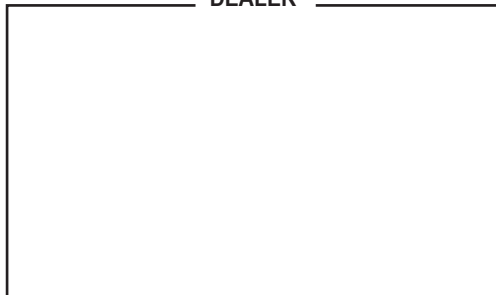

Cod. 8050832 - 3<sup>a</sup> ed. - 04/2022

## GHIBLI & WIRBEL S.p.A.

Registered office:

Via Enrico Fermi, 43 - 37136 Verona (VR) - Italy

Headquarters:

Via Circonvallazione, 5 - 27020 Dorno (PV) - Italy

P. +39.0382.848811 - F. +39.0382.84668 - M. info@ghibliwirbel.com

[www.ghibliwirbel.com](http://www.ghibliwirbel.com)

100% MADE IN ITALY



ISO 9001

